

# CEPEX Plastic Extreme Diaphragm Valve Series

## Industrial Plastic Diaphragm Valve Range

ALLVALVES  
ONLINE

### Main Features :-

Spanish made valves, CE marked.

Body is PVC/CPVC and PP-H

EPDM or Viton seal

PN10 Rated

Standards incl DIN, ANSI and SDR11

Available manual or actuated

High Quality product



TYPE: CEPEX VALVES

### Technical Details:-

## CARACTERÍSTICAS TÉCNICAS Y GAMA TECHNICAL FEATURES AND RANGE

→ **Medidas | Measures:**  
D20 (DN15) > D63 (DN50)

→ **Presión nom. | Nom. pressure:**  
PN10 / 20°C (150 psi / 73°F)

→ **Standards:**  
DIN (metric / BSP)  
ANSI (ASTM / NPT)  
SDR11 > PE100

→ **Material cuerpo | Body material:**  
PVC-U / PVC-C / PP-H

→ **Mat. membrana | Membrane mat.:**  
EPDM (indicador visual azul)  
(blue visual indicator)

FPM (indicador visual verde)  
(green visual indicator)

→ **Certificado CE | CE Certificate:**  
EN ISO 16138

→ **Uniones  
Unions:**  
3 piezas, encolar hembra  
3 pieces, female solvent socket

3 piezas, roscar hembra  
3 pieces, female thread

Encolar macho  
Male solvent socket

Termofusión  
Socket fusion

Bridas  
Flanges

Soldadura a tope y electrofusión  
Butt welding and electrofusion

Presión vs. temperatura  
Pressure vs. temperature

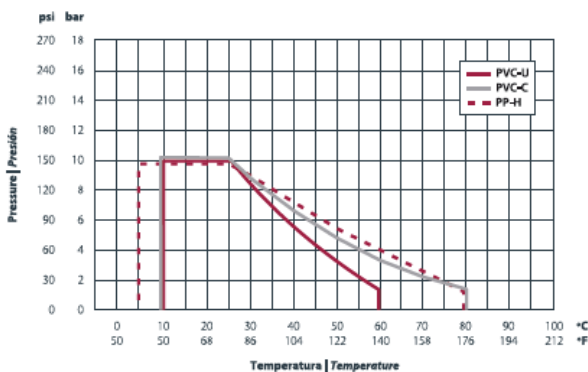

Flujo relativo  
Relative flow

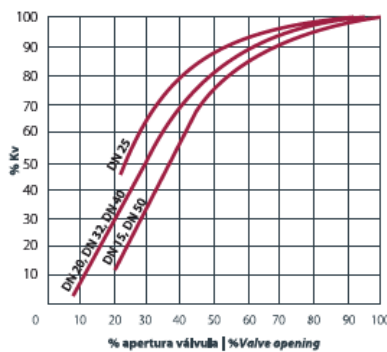

Pérdida de presión  
Pressure loss

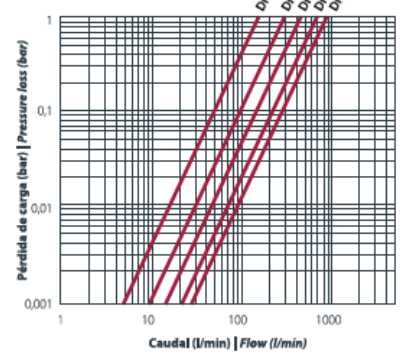

ISO 9001:2015 Accredited Company

Tel: +44(0)1386 552369

Fax: +44(0)1386 554227

sales@allvalves.co.uk

www.allvalves.co.uk

Allvalves Online Ltd, Automation House, Unit 2, Pershore, WR10 2DF UK

### DESPIECE | EXPLODED

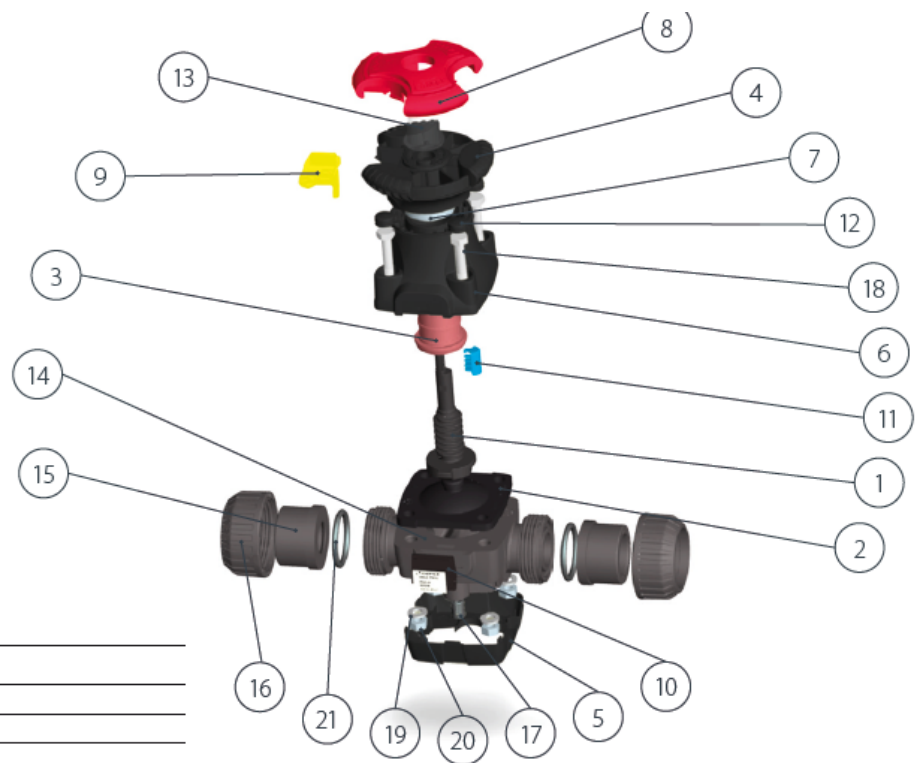

TYPE: CEPEX VALVES

Description	Material
1 Eje / Stem	PPO+GF
2 Diafragma / Diaphragm	EPDM/FPM
3 Guía / Guide	POM
4 Volante / Handwheel	PP+GF
5 Tapa inferior / Lower cover	PP
6 Tapa / Cover	PP+GF
7 Arandela / Washer	POM
8 Tapón superior / Top cover	PP
9 Seguro / Safety lock	PP+GF
10 Porta-etiqueta / Label holder	ABS
11 Indicador / Indicator	PP
12 Tapón tornillo / Screw cap	PP
13 Tapón indicador / Indicator cap	PC
14 Cuerpo / Body	PVC-U/CPVC/PP
15 Manguito / End connector	PVC-U/CPVC/PP
16 Tuerca / Union nut	PVC-U/CPVC/PP
17 Inserto / Insert	Acero inoxidable / Stainless steel
18 Tornillo DIN 931 / DIN 931 screw	Acero inoxidable / Stainless steel
19 Arandela grower DIN 127 / DIN 127 grower washer	Acero inoxidable / Stainless steel
20 Tuerca DIN 934 / DIN 934 nut	Acero inoxidable / Stainless steel
21 Junta tórica / O-ring	EPDM/FPM

#### Más características

- Marcado láser
- Trazabilidad 100 %: número de serie y de lote
- 100 % testadas en banco de presión con agua.

#### More features:

- Laser marking
- 100 % traceability: serial and batch number
- 100 % valves tested in water pressure test bench.

**Encolar hembra**  
Female solvent socket  
PVC-U | PVC-C

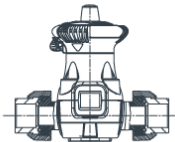

**Encolar macho**  
Male solvent socket  
PVC-U | PVC-C

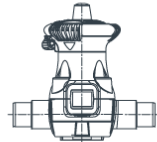

**Soldadura a tope SDR11**  
Butt welding SDR11  
PP-H | PE100

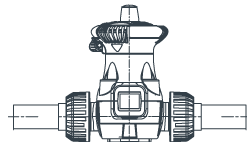

**Con bridas**  
With flanges  
PVC-U | PVC-C

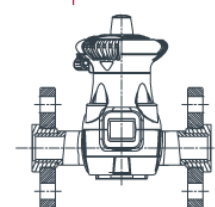

**Roscar hembra**  
Female thread  
PVC-U | PVC-C | PP-H

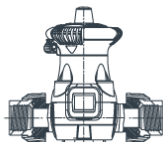

**Termofusión hembra**  
Female socket fusion  
PP-H

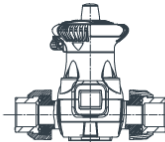

**Electrosoldable**  
Electrofusion  
PE100

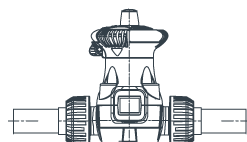

ISO 9001:2015 Accredited Company

Tel: +44(0)1386 552369

Fax: +44(0)1386 554227

sales@allvalves.co.uk

www.allvalves.co.uk

Allvalves Online Ltd, Automation House, Unit 2, Pershore, WR10 2DF UK

# CEPEX Plastic Extreme Diaphragm Valve Series

## Industrial Plastic Diaphragm Valve Range



Pneumatic actuation in all versions of the diaphragm valve Extreme Series.

**FESTO actuator, specially designed for CEPEX diaphragm valves**

#### Actuation options:

- Spring return with normally closed valve
- Doble acting

#### Optional accessories:

- Possibility of mechanical adjustment of the valve opening
- Possibility of mounting the solenoid included in the actuator
- Analogue Position transmitter
- Magnetic sensors incorporated in the cylinder
- Speed control through flow regulators

Actuación neumática en todas las versiones de válvula de diafragma Serie Extreme.

**Actuador FESTO, diseñado especialmente para válvulas de diafragma CEPEX**

#### Opciones de actuación:

- Simple efecto con válvula normalmente cerrada
- Doble efecto

#### Accesorios opcionales:

- Posibilidad de ajuste mecánico de la apertura de la válvula
- Posibilidad de montaje de la electroválvula incorporada al actuador
- Transmisor analógico de posición
- Detectores magnéticos incorporados al cilindro
- Ajuste de velocidad a través de reguladores de caudal

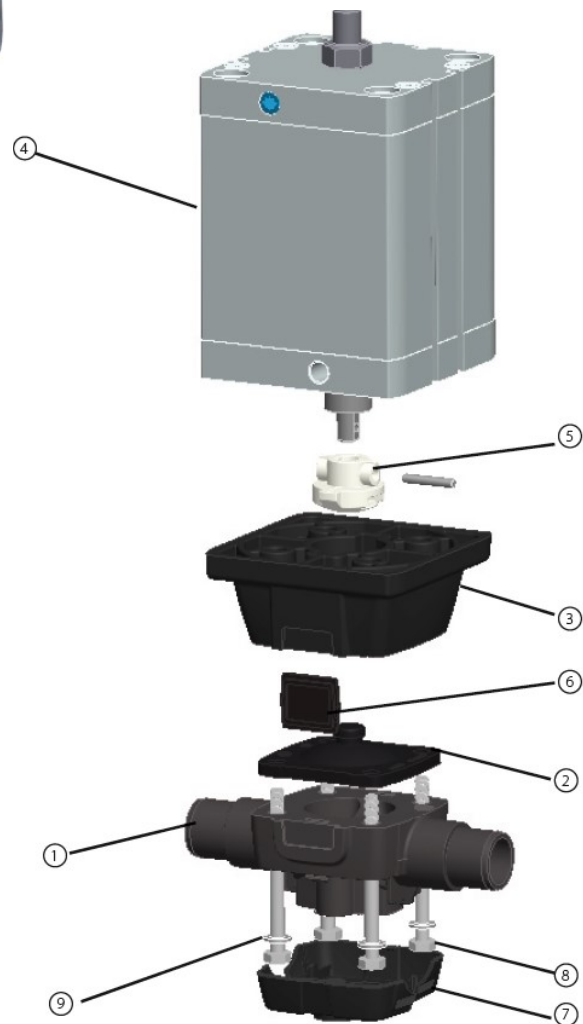

### DESPIECE | EXPLODED

Description	Material
1 Cuerpo / Body	PVC-U / CPVC / PPH
2 Diafragma / Diaphragm	EPDM / FPM
3 Brida unión / Mounting clamp	PA
4 Actuador / Actuator	Aluminium
5 Prensa	POM
6 Porta-etiqueta / Label holder	ABS
7 Tapa inferior / Lower cover	PP
8 Tornillo / Screw	AISI-304
9 Arandela / Washer	AISI-304

TYPE: CEPEX VALVES

ISO 9001:2015 Accredited Company

Tel: +44(0)1386 552369

Fax: +44(0)1386 554227

sales@allvalves.co.uk

www.allvalves.co.uk

Allvalves Online Ltd, Automation House, Unit 2, Pershore, WR10 2DF UK